

NOTE:

1. SPECIFY HEIGHT 'HT' WHEN ORDERING, 4 1/2" MINIMUM, 24" MAX
2. TAPPED HOLE PATTERN IN TOP FLANGE IS ALIGNED WITH CENTERLINE OF GROMMET OPENINGS.
3. 2" GROMMET OPENINGS ARE ORIENTED 180° APART. OTHER HOLE SIZES AND/OR LOCATIONS MUST BE SPECIFIED WHEN ORDERING.
4. (2) Ø2" GROMMETS (STD) ARE SHIPPED UNASSEMBLED WITH SECTION.
5. PLYWOOD OR POLYOYMER COVER IS EXTERIOR GRADE CC.
 - L-868 8" 3/4" THICK
 - L-868 3/4" THICK
 - L-868 1 1/4" THICK
6. A COPPER GROUND LUG IS INCLUDED.
7. CARBON STEEL SECTIONS ARE HOT DIP GALVANIZED PER ASTM A123.
8. AVAILABLE OPTIONS, SPECIFIED WHEN ORDERING, INCLUDE:
 - DRAIN COUPLING
 - ANTI-ROTATION FINS AND/OR ANTI-UPLIFT BARS
 - STAINLESS STEEL CONSTRUCTION
 - REPLACEABLE STAINLESS STEEL THREADED INSERTS
9. GROUND STRAP WILL BE PLACED IN CENTER LINE OF THE CAN UP TO 15" OVER 15" WILL BE 6" FROM THE TOP.
10. THIS PRODUCT IS CERTIFIED PER FAA ADVISORY CIRCULAR AC150/5345-42 (CURRENT REV)

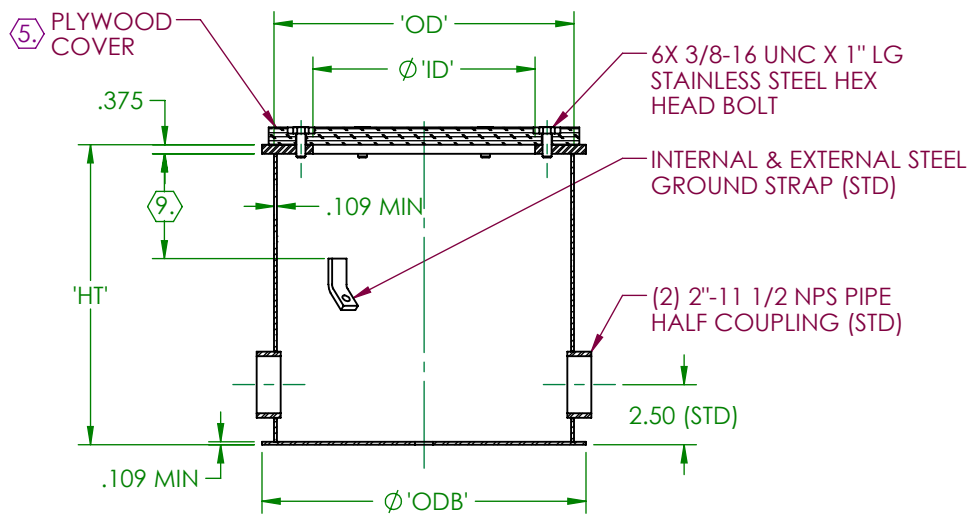

SECTION A-A
WITH PLYWOOD COVER
AND MACHINE SCREWS

FAA TYPE	NOM DIA	MMC TYPE	'OD'	'BC'	'ID'	'ODB'	'ODT'
L-868A	8"	88BSC	8.500	6.250	5.250	9.500	9.500
L-868B	12"	128BSC	12.500	10.250	9.250	13.500	13.500
L-868C	15"	158BSC	15.500	13.250	12.375	16.500	16.500

DWN: DOUG F.	L-868 BOTTOM SECTION W/COUPLINGS	
DATE: 7/26/2017		
SCALE: NTS		622 6TH ST. SO. WINSTED, MN 55395
SHEET 1 OF 1		

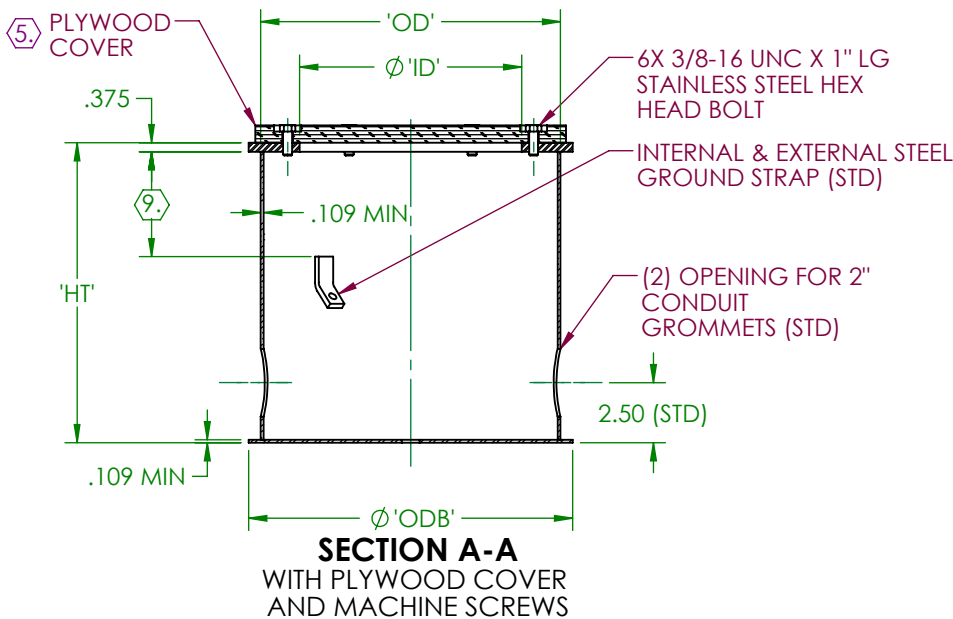
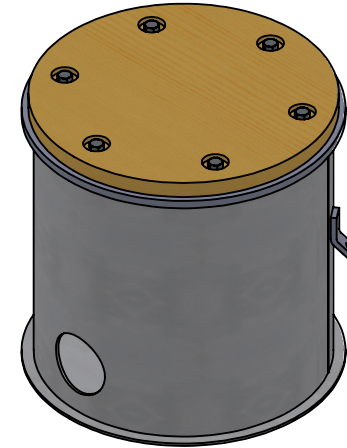
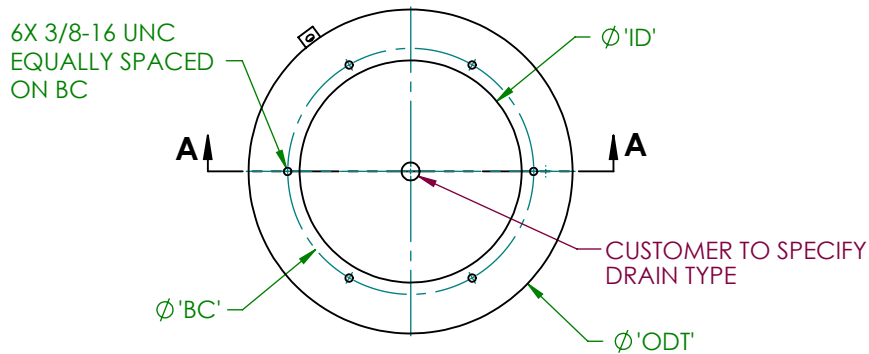

NOTE:

1. SPECIFY HEIGHT 'HT' WHEN ORDERING, 4 1/2" MINIMUM, 24" MAX
2. TAPPED HOLE PATTERN IN TOP FLANGE IS ALIGNED WITH CENTERLINE OF GROMMET OPENINGS.
3. 2" GROMMET OPENINGS ARE ORIENTED 180° APART. OTHER HOLE SIZES AND/OR LOCATIONS MUST BE SPECIFIED WHEN ORDERING.
4. (2) Ø2" GROMMETS (STD) ARE SHIPPED UNASSEMBLED WITH SECTION.
5. PLYWOOD OR POLYOYMER COVER IS EXTERIOR GRADE CC.
 - L-868 8" 3/4" THICK
 - L-868 3/4" THICK
 - L-868 1 1/4" THICK
6. A COPPER GROUND LUG IS INCLUDED.
7. CARBON STEEL SECTIONS ARE HOT DIP GALVANIZED PER ASTM A123.
8. AVAILABLE OPTIONS, SPECIFIED WHEN ORDERING, INCLUDE:
 - DRAIN COUPLING
 - ANTI-ROTATION FINS AND/OR ANTI-UPLIFT BARS
 - STAINLESS STEEL CONSTRUCTION
 - REPLACEABLE STAINLESS STEEL THREADED INSERTS
9. GROUND STRAP WILL BE PLACED IN CENTER LINE OF THE CAN UP TO 15" OVER 15" WILL BE 6" FROM THE TOP.
10. THIS PRODUCT IS CERTIFIED PER FAA ADVISORY CIRCULAR AC 150/5345-42 (CURRENT REV).

FAA TYPE	NOM DIA	MMC TYPE	'OD'	'BC'	'ID'	'ODB'	'ODT'
L-868A	8"	88BSG	8.500	6.250	5.250	9.500	9.500
L-868B	12"	128BSG	12.500	10.250	9.250	13.500	13.500
L-868C	15"	158BSG	15.500	13.250	12.375	16.500	16.500

DWN: DOUG F.	L-868 BOTTOM SECTION WITH GROMMETS	
DATE: 7/26/2017		
SCALE: NTS		622 6TH ST. SO. WINSTED, MN 55395
SHEET 1 OF 1		

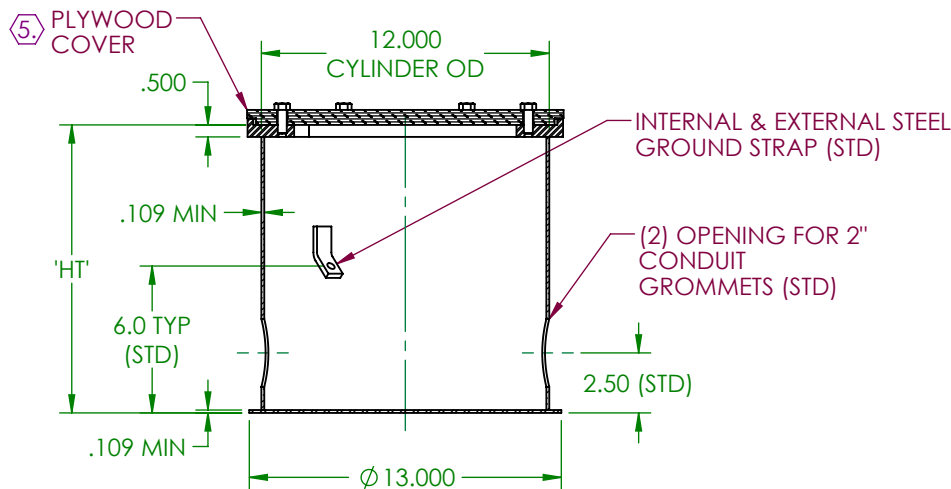
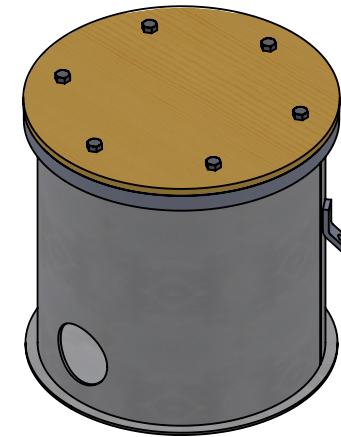
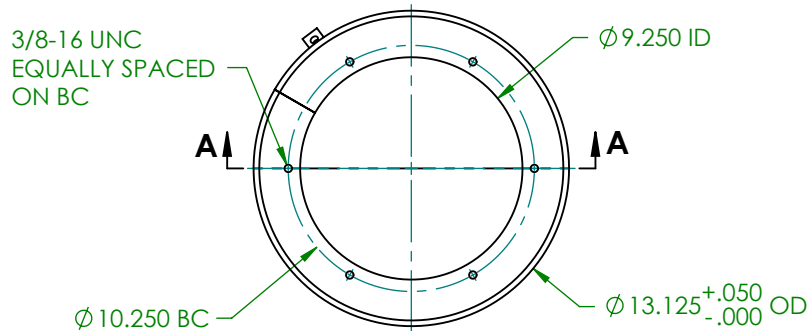

SECTION A-A
WITH PLYWOOD COVER
AND MACHINE SCREWS

NOTE:

1. SPECIFY HEIGHT 'HT' WHEN ORDERING, 4 1/2" MINIMUM.
2. TAPPED HOLE PATTERN IN TOP FLANGE IS ALIGNED WITH CENTERLINE OF GROMMET OPENINGS.
3. 2" GROMMET OPENINGS ARE ORIENTED 180° APART. OTHER HOLE SIZES AND/OR LOCATIONS MUST BE SPECIFIED WHEN ORDERING.
4. (2) $\phi 2$ " GROMMETS (STD) ARE SHIPPED UNASSEMBLED WITH SECTION.
5. PLYWOOD COVER IS EXTERIOR GRADE CC, 5/8" THICK.
6. A COPPER GROUND LUG IS INCLUDED.
7. CARBON STEEL SECTIONS ARE HOT DIP GALVANIZED PER ASTM A123.
8. AVAILABLE OPTIONS, SPECIFIED WHEN ORDERING, INCLUDE:
 - DRAIN COUPLING
 - ANTI-ROTATION FINS AND/OR ANTI-UPLIFT BARS
 - STAINLESS STEEL CONSTRUCTION
 - REPLACEABLE STAINLESS STEEL THREADED INSERTS
9. THIS PRODUCT IS CERTIFIED PER FAA ADVISORY CIRCULAR AC150/5345-42 (CURRENT REV).

DWN: DOUG F.	L-868 BOTTOM SECTION WITH GROMMETS, ALASKA	
DATE: 1/3/2020		
SCALE: NTS	 622 6TH ST. SO. WINSTED, MN 55395	128BSGA
SHEET 1 OF 1		